

DEPARTMENT OF THE ARMY TECHNICAL MANUAL

---

DIRECT SUPPORT, GENERAL SUPPORT,  
AND DEPOT MAINTENANCE REPAIR PARTS AND  
SPECIAL TOOLS LIST

TELESCOPE, ELBOW M92F (1240-886-5888)

---

HEADQUARTERS, DEPARTMENT OF THE ARMY

SEPTEMBER 1970

TECHNICAL MANUAL }  
No. 9-1240-3356-35P }

HEADQUARTERS  
DEPARTMENT OF THE ARMY  
WASHINGTON, D.C., 24 September 1970

**DIRECT SUPPORT, GENERAL SUPPORT, AND DEPOT  
MAINTENANCE REPAIR PARTS AND SPECIAL TOOLS LIST  
TELESCOPE, ELBOW M92F (1240-886-5888)**

*This manual is current as of 24 September 1970*

SECTION		Paragraph	Page
I.	INTRODUCTION		
	Scope .....	1	
	General .....	2	1
	Explanation of columns .....	3	1
	Special Information .....	4	2
	How to locate repair parts.....	5	3
	Abbreviations.....	6	3
	Federal supply codes for manufacturers .....	7	8
	Recommendations for maintenance publications .....	8	8
II.	REPAIR PARTS FOR DIRECT SUPPORT, GENERAL SUPPORT, AND DEPOT MAINTENANCE.....		5
III.	SPECIAL TOOLS, TEST AND SUPPORT EQUIPMENT FOR DIRECT SUPPORT, GENERAL SUPPORT, AND DEPOT MAINTENANCE .....		Not Applicable
IV.	INDEX-FEDERAL STOCK NUMBER AND REFERENCE NUMBER CROSS-REFERENCE TO FIGURE AND ITEM NUMBER.....		14

\*This manual supersedes SM ORD8 SNL F391, 5 Apr 54 and SM ORD9 SNL F391, 11 Apr 56 including all changes.

**SECTION I. INTRODUCTION**

**1. Scope**

This manual lists repair parts, special tools, and equipment required for the performance of direct support, general support, and depot maintenance of the Telescope, Elbow M92F.

**2. General**

This Repair Parts and Special Tools List is divided into the following sections:

*a. Repair Parts-Section II.* A list of repair parts for the performance of maintenance at the direct support, general support, and depot level in figure and item number sequence.

*b. Special Tools, Test and Support Equipment-Section III.* A list of special tools, test and support equipment for the performance of maintenance at the direct support, general support, and depot level.

*c. Federal Stock Number and Reference Number Index - Section IV.* A list of Federal Stock Numbers in ascending numerical sequence followed by a list of reference numbers in ascending alpha-numeric sequence, cross-referenced to the illustration figure number and item number.

**3. Explanation of Columns**

The following provides an explanation of columns in the tabular lists in Sections II and III.

*a. Source Maintenance and Recoverability Codes (SMR). Column A:*

(1) Source code, indicates the selection status and source for the listed item. Source codes are:

<i>Code</i>	<i>Explanation</i>
P	Repair parts, special tools, and test equipment which are stocked in or supplied from the GSA/DSA, or Army supply system and authorized for use at indicated maintenance categories.
P2	Repair Parts, special tools, and test equipment which are procured and stocked for insurance purposes because the combat or military essentiality of the end items dictates that a minimum quantity be available in the supply system.
P9	Assigned to items which are NSA design controlled; unique repair parts, special tools, test, measuring and diagnostic equipment, which are stocked and supplied by the Army Comsec logistic systems, and which are not subject to the provisions of AR 380-41.
P10	Assigned to items which are NSA design controlled; special tools, test measuring and diagnostic equipment for Comsec support, which are accountable under the provision of

<i>Code</i>	<i>Explanation</i>
	AR 380-41, which are stocked and supplied by the Army Comsec logistic system.
M	Repair parts, special tools and test equipment which are to be manufactured at indicated maintenance levels.
A	Assemblies which are not procured or stocked as such, but are made up of two or more units. Such component units carry individual stock numbers and descriptions, are procured and stocked separately and can be assembled to form the required assembly at indicated maintenance categories.
X	Parts and assemblies which are not procured or stocked and the mortality of which normally is below that of the applicable end item or component. The failure of such part or assembly should result in retirement of the end item from the supply system.
X1	Repair parts which are not procured or stocked. The requirements for such items will be filled by use of the next higher assembly or component.
X2	Repair parts, Special Tools and Test Equipment which have no foreseen mortality. The indicated maintenance category requiring such repair parts will attempt to obtain same through cannibalization and/or salvage. When such items are not obtainable through cannibalization or salvage, the item may be requisitioned with accompanying justification, through normal supply channels.
G	Major assemblies that are procured with PEMA funds for initial issue only as exchange assemblies at DSU and GSU level. These assemblies will not be stocked above DS and GS level or returned to depot supply level.
	(2) Maintenance code, indicates the lowest category of maintenance authorized to install the listed item. The maintenance level codes are:
<i>Code</i>	<i>Explanation</i>
C	Crew or operator maintenance
O	Organizational maintenance
F	Direct support maintenance
H	General support maintenance
D	Depot maintenance.
	(3) Recoverability Codes. The following codes will be used when the responsible Army activity desires the return of unserviceable repair parts, special tools and test equipment:
<i>Code</i>	<i>Explanation</i>
R	Applies to repair parts (assemblies and components) special tools and test equipment which are considered economically repairable at direct and general support maintenance levels. Then the item is no longer economically repairable it is normally disposed of at the GS level. When supply considerations dictate, some of these repair parts may be listed for automatic return to supply for depot level repair as set forth in AR 710-50. When so listed, they will be replaced by supply on an exchange basis.

<i>Code</i>	<i>Explanation</i>
S	Repair parts, special tools, test equipment and assemblies which are economically repairable at DSU and GSU activities and which normally are furnished by supply on an exchange basis. When items are determined by a GSU to be uneconomically repairable, they will be evacuated to a depot for evaluation and analysis before final disposition.
T	High dollar value recoverable repair parts, special tools and test equipment which are subject to special handling and are issued on an exchange basis. Such items will be evacuated to the depot for overhaul or final disposition. This criteria is interpreted as including items like engines even though minor adjustments/ repairs are authorized at below depot level. Communications-Electronics and Missile Support Items will be repaired/overhauled only at depots.
U	Repair parts, special tools and test equipment specifically selected for salvage by reclamation units because of precious metal content, critical materials, high dollar value or reusable casings or castings.

*b. Federal Stock Number, Column 2.* This column indicates the Federal Stock Number assigned to the item and will be used for requisitioning purposes.

*c. Description, Column 3.* This column indicates the Federal item name and any additional description of the item required. The abbreviation "w/e" when used as a part of the nomenclature, indicates the Federal stock number includes all armament, equipment, accessories, and repair parts issued with the item. A part number or other reference number is followed by the applicable five-digit Federal supply code for manufacturers in parentheses.

*d. Unit of Measure (U/M), Column 4.* A 2 character alphabetic abbreviation indicating the amount or quantity of the item upon which the allowances are based e.g., ft, ea, pr, etc.

*e. Quantity Incorporated in Unit, Column 5.* This column indicates the quantity of the item used in the assembly or the portion illustrated. A "V" appearing in this column in lieu of a quantity indicates that a definite quantity cannot be indicated, (e.g., shims, spacers, gaskets, etc.).

*f. 30-Day DS/GS Maintenance Allowances, Columns 6 and 7.*

**NOTE**

**Allowances in GS column are for GS maintenance only.**

(1) The allowance columns are divided into three subcolumns. Indicated in each subcolumn, opposite the first appearance of each item, is the total quantity of items authorized for the number of equipments supported. Subsequent appearances of the

same item will have the letters "REF" in the applicable allowance columns. Items authorized for use as required but not for initial stockage are identified with an asterisk in the allowance column.

(2) The quantitative allowances for DS/ GS levels of maintenance will represent initial stockage for a 30-day period for the number of equipments supported.

(3) Determination of the total quantity of parts required for maintenance of more than 100 of these equipments can be accomplished by converting the equipment quantity to a decimal factor by placing a decimal point before the next to last digit of the number to indicate hundredths and multiplying the decimal factor by the parts quantity authorized in the 51-100 allowance column. Example, authorized allowance for 51-100 equipments is 40; for 150 equipments multiply 40 by 1.50 or 60 parts required

*g. 1-Year Allowances Per 100 Equipments/ Contingency Planning Purposes, Column 8.* This column indicates opposite the first appearance of each item the total quantity required for distribution and contingency planning purposes. The range of items indicates total quantities of all authorized items required to provide for adequate support of 100 equipments for one year.

*h. Depot Maintenance Allowance Per 100 Equipments, Column 9.* This column indicate: opposite the first appearance of each item, the total quantity authorized for depot maintenance of 100 equipments. Subsequent appearances of the same item will have the letters "REF" in the allowance column. Items authorized for us as required but not for initial stockage are identified with an asterisk in the allowance column.

*i. Illustration Column 10.* This column is divided as follows:

(1) *Item number column 10a.* Indicates the figure number of the illustration in which the item is shown.

(2) *Figure number column 10b.* Indicate the callout number used to reference the item in the illustration.

**4. Special Information**

*a.* Action change codes indicated in the left hand margin of the listing page denote the following:

N-Indicates an added item not included in previous publications.

C-Indicates a change in data.

F-Indicates a change in FSN only.

b. The following publications pertain to Telescope, Elbow M92F:

TM 9-1015-221-20P	Organizational Maintenance Repair Parts, and Special Tool Lists for Rifle, Recoiless, 106MM M40A1
TM 9-1-2 -20P	Organizational Maintenance Repair Parts, and Special Tool Lists for Rifle, Self-Propelled 106MM M50

c. To maintain disassembly sequence in this manual, a sequence number in parentheses will be displayed immediately to the right of the callout number on the illustration.

**5. How to Locate Repair Parts**

a. When Federal Stock Number or reference number is unknown:

(1) *First.* Find the illustration covering the assembly group to which the repair part belongs.

(2) *Second.* Identify the repair part on the illustration and note the illustration figure and item number of the repair part.

(3) *Third.* Using the Repair Parts Listing, find the assembly group to which the repair part belongs and locate the illustration figure and item number noted on the illustration.

b. When Federal Stock number or reference number is known:

(1) *First.* Using the Index of Federal Stock Numbers and Reference Numbers find the pertinent Federal Stock number or reference number. This index is in ascending FSN sequence followed by a list of reference numbers in ascending alpha-numeric sequence, cross-referenced to the illustration figure number and item number.

(2) *Second.* Using the Repair Part Listing, find the assembly group of the repair part and the illustration figure number and item number referenced in the Index of Federal Stock Numbers and Reference Numbers.

**6. Abbreviations**

<i>Abbreviations</i>	<i>Explanation</i>
al-----	aluminum
aly-----	alloy
assy-----	assembly
brs-----	brass
cd pl-----	cadmium plate

<i>Abbreviations</i>	<i>Explanation</i>
cp-----	cone point
cprsn-----	compression
cres-----	corrosion resistant steel
dia-----	diameter
dwl-----	dowel
elem-----	element
ext-----	external
fp-----	flat point
fnsh-----	finish
gl-----	glass
hex soc-----	hexagon socket
hlcl-----	helical
hldr-----	holder
id-----	inside diameter
l-----	long
M-----	level
ms-----	Military Standard
muw-----	music wire
no-----	number
ns-----	National special (thread)
oa-----	overall
od-----	outside diameter
opt-----	optical
pnh-----	panhead
psvt-----	passivate
rec-----	recess
sld-----	sealed
sld-----	slotted
spr-----	spring
thd-----	thread
tlscp-----	telescope
thk-----	thick
unf-----	unified fine thread

**7. Federal Supply Codes for Manufacturers**

<i>Code</i>	<i>Manufacturer</i>
00000	Ordnance Corps
10001	Naval Ordnance Systems Command Washington, D.C. 20360
19200	Frankford Arsenal, Philadelphia, Pa.
21450	Ordnance Corps Engineering Standards, Rock Island Arsenal, Rock Island, I1.
96906	Military Standard Promulgated by Standardization Division, Directorate of Logistic Services DSA

**8. Recommendations for Maintenance Publication Improvements**

Report of errors, omissions, and recommendations for improving this publication by the individual user is encouraged. Reports should be submitted on DA Form 2028 (Recommended Changes to DA Publications) and forwarded directly to The Commanding Officer Frankford Arsenal, ATTN: AMSWE-SMF-W3100, Philadelphia, Pa. 19137.

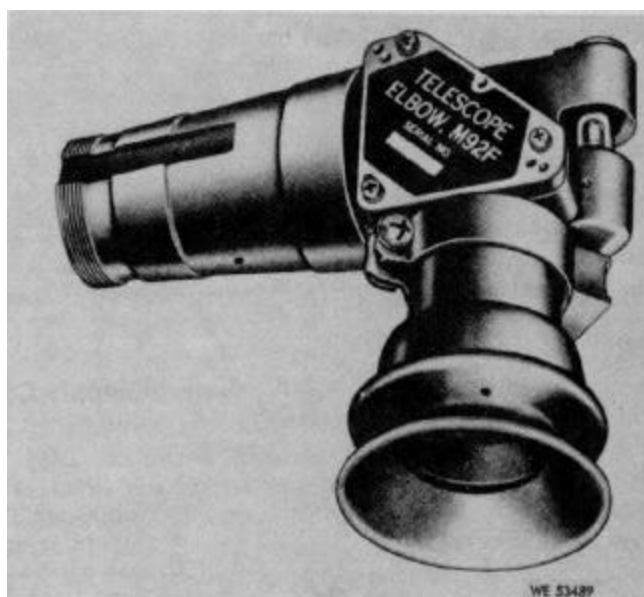

Figure 1. Elbow telescope M92F.

**SECTION II. DIRECT SUPPORT, GENERAL SUPPORT AND DEPOT MAINTENANCE REPAIR PARTS LIST**

Act on code	(1) SMR code	(2) Federal stock No.	(3) Description <i>Reference Number &amp; Mfg Code Usable On Code</i>	(4) Unit of Meas	(5) Qty inc in unit	(6) 30-Day DS Maint Allowance			(7) 30-Day GS Maint Allowance			(8) 1-yr alw per 100 equip cntgcy	(9) Depot maint Alw per 100 equip	(10) Illustration	
						(a)	(b)	(c)	(a)	(b)	(c)			(a) Figure No.	(b) Item No.
						1-20	21-50	51-100	1-20	21-50	51-100				
N	P- O-	1240-346-7676	<b>ELBOW TELESCOPE M92F</b> EYESHIELD 8228878 (19200)	EA	1	*	1	2	*	1	2	24	10	2	1
N	P-H-	5305-068-6708	SETSCREW HEX SOC, CP, CRES, PSVT FNSH, NO 2 64UNF-3A, 1/8 L M551038-16 (96906)	EA	1	--	--	--	*	1	2	24	10	2	2
C	A-		EYEPIECE ASSEMBLY 7649238 (19200)		1	--	--	--	--	--	--	--	--	2	3
C	P-H-	1240-764-9250	RING, EXTERNALLY THREADED AL ALY, 0.593 DIA, 0.825-48NS-3 OD, 0.08 L OA 7649250 (19200)	EA	1	--	--	--	*	*	1	12	4	2	4
C	P-F-	1240-763-7894	BAND, TELESCOPE ASSEMBLY 7637894 (19200)	EA	1	*	*	1	*	*	1	12	6	2	5
N	P-F-	5305-057-0524	SCREW, MACHINE PNH, CROSS, REC, CRES, PSVT FNSH, NO 6 40UNF-2A, 3/8 L MS51958-28 (96906)	EA	1	*	1	2	*	1	2	24	10	2	6
N	P-F-	5310-929-6395	WASHER, LOCK SPR, HLCL, CRES, PSVT FNSH, NO 10, 0.250 OD, 0.031 THK MS35338-136 (96906)	EA	1	*	1	2	*	1	2	24	10	2	7
C	P-H-	1240-764-9244	WINDOW GL, 0.093 DIA, S/32 OA 7649244 (19200)	EA	1	--	--	--	*	1	2	24	10	2	8
N	P-H-	5305-068-1654	SETSCREW HEX SOC, FP, CRES, PSVT FNSH, NO 2 64UNF-3A, 1/8 L MS51031-8 (96906)	EA	4	--	--	--	1	1	2	24	20	2	9
N	A-		RETICLE ASSEMBLY 8286981 (19200)		1	--	--	--	--	--	--	--	--	2	10
C	A-		OBJECTIVE, BONDED 7649239 (19200)		1	--	--	--	--	--	--	--	--	2	11
N	P-H-	5305-057-0500	SCREW, MACHINE PNH, CROSS REC, CRES, PSVT FNSH, NO 2 64UNF-2A, 5/16 L MS51958-4 (96906)	EA	3	--	--	--	*	1	2	24	10	2	12

Act on code	(1) SMR code	(2) Federal stock No.	(3) Description <i>Reference Number &amp; Mfg Code Usable On Code</i>	(4) Unit of Meas	(5) Qty inc in unit	(6) 30-Day DS Maint Allowance			(7) 30-Day GS Maint Allowance			(8) 1-yr alw per 100 equip cntgcy	(9) Depot maint Alw per 100 equip	(10) Illustration	
						(a)	(b)	(c)	(a)	(b)	(c)			(a) Figure No.	(b) Item No.
						1-20	21-50	51-100	1-20	21-50	51-100				
N	P-F-	5310-928-2690	WASHER, LOCK SPR, HLCL, CRES, PSVT FNSH, NO 2, 0.172 OD, 0.020 THK MS35338-134 (96906)	EA	3	*	1	2	*	1	21	24	10	2	13
N	P-H-	9905-223-7172	PLATE, IDENTIFICATION 8286926 (19200)	EA	1	--	--	--	*	*	1	12	6	2	14
C	P-H-	1240-507-9525	PRISM, OPTICAL INSTRUMENT 8299684 (19200)	EA	1	--	--	--	*	*	1	12	6	2	15
N	P-H-	5315-806-7039	PIN, STRAIGHT, HEADLESS DWL CRES, PSVT FNSH, 1/16 DIA, 3/8 L MS16555-604 (96906)	EA	2	--	--	--	*	*	1	12	5	2	16
C	P-F-	1240-759-7277	RETAINER SLTD, BRS, 0.426-32NS-3X 0.180 OA 7597277 (19200)	EA	1	*	*	1	*	*	1	12	10	2	17
C	P-F-	1240-759-7275	ECCENTRIC LVL VIAL, TLSCP HLDR 7597275 (19200)	EA	1	*	1	2	*	1	2	24	10	2	18
C	P-F-	5340-597-0717	SPRING, HELICAL CPRSN, MUW, 0.30 L, 7 COIL 7646896 (19200)	EA	1	*	1	2	*	1	2	24	10	2	19
C	P-F-	1240-764-7118	TUBE, LEVEL VIAL ASSY (SLD) 7647118 (19200)	EA	1	*	*	1	*	*	1	12	6	2	20
N	P-F-	5315-844-3942	PIN, SPRING, TUBULAR SLTD, CD PL,, 1/16 DIA, 1/2 L MS16562-6 (96906)	EA	1	*	1	2	*	1	2	24	20	2	21
N	X-		BODY 8299681 (19200)		1	--	--	--	--	--	--	--	--	2	22



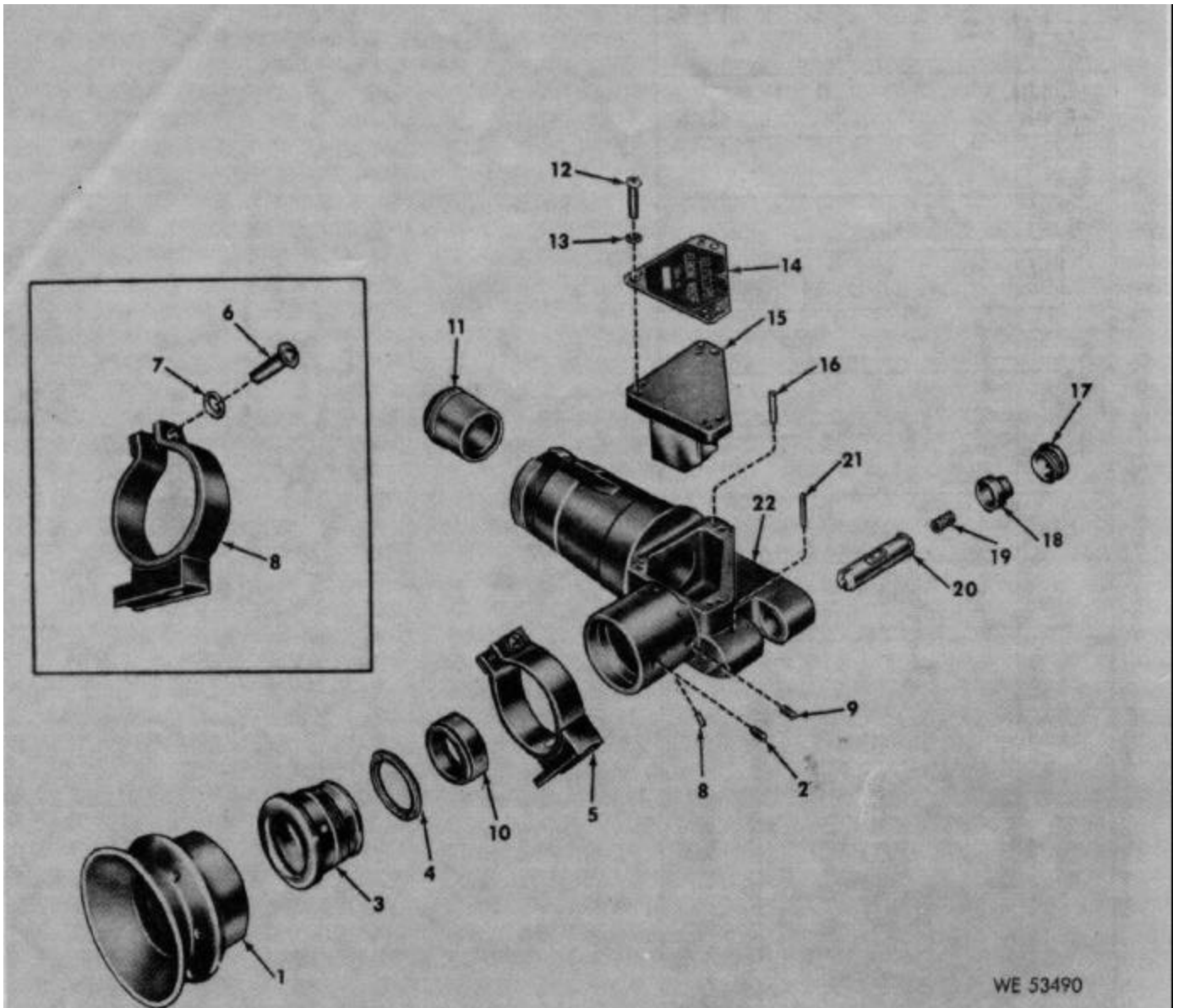

Figure 2. Elbow telescope M92F-exploded view.

Act on code	(1) SMR code	(2) Federal stock No.	(3) Description <i>Reference Number &amp; Mfg Code Usable On Code</i>	(4) Unit of Meas	(5) Qty inc in unit	(6) 30-Day DS Maint Allowance			(7) 30-Day GS Maint Allowance			(8) 1-yr alw per 100 equip cntgcy	(9) Depot maint Alw per 100 equip	(10) Illustration	
						(a)	(b)	(c)	(a)	(b)	(c)			(a) Figure No.	(b) Item No.
						1-20	21-50	51-100	1-20	21-50	51-100				
N	P-H	5305-753-7062	<b>EYEPIECE ASSEMBLY 7649238</b> SETSCREW 541823 (00000)	EA	1	--	--	--	*	1	2	24	50	3	1
C	P-H	1240-764-9249	CELL, OPT ELEM AL-ALY 0.521 1D, 0.72 OD 0.147 THK, 0.648-48NS-3 EXT THD 7649249 (19200)	EA	1	--	--	--	*	*	1	12	10	3	2
C	P-H	1240-503-7651	LENS, OPTICAL INSTRUMENT 5037651 (19200)	EA	2	--	--	--	*	1	1	12	5	3	3
N	P-H	1240-764-9252	SPACER, OPT ELEM AL-ALY, 0.652 ID, 0.719 OD, 0.153 THK 7649252 (19200)	EA	1	--	--	--	*	*	1	12	4	3	4
C	P-H	1240-764-9246	CELL, OPTICAL ELEMENT 7649246 (12900)	EA	1	--	--	--	*	*	1	12	4	3	6

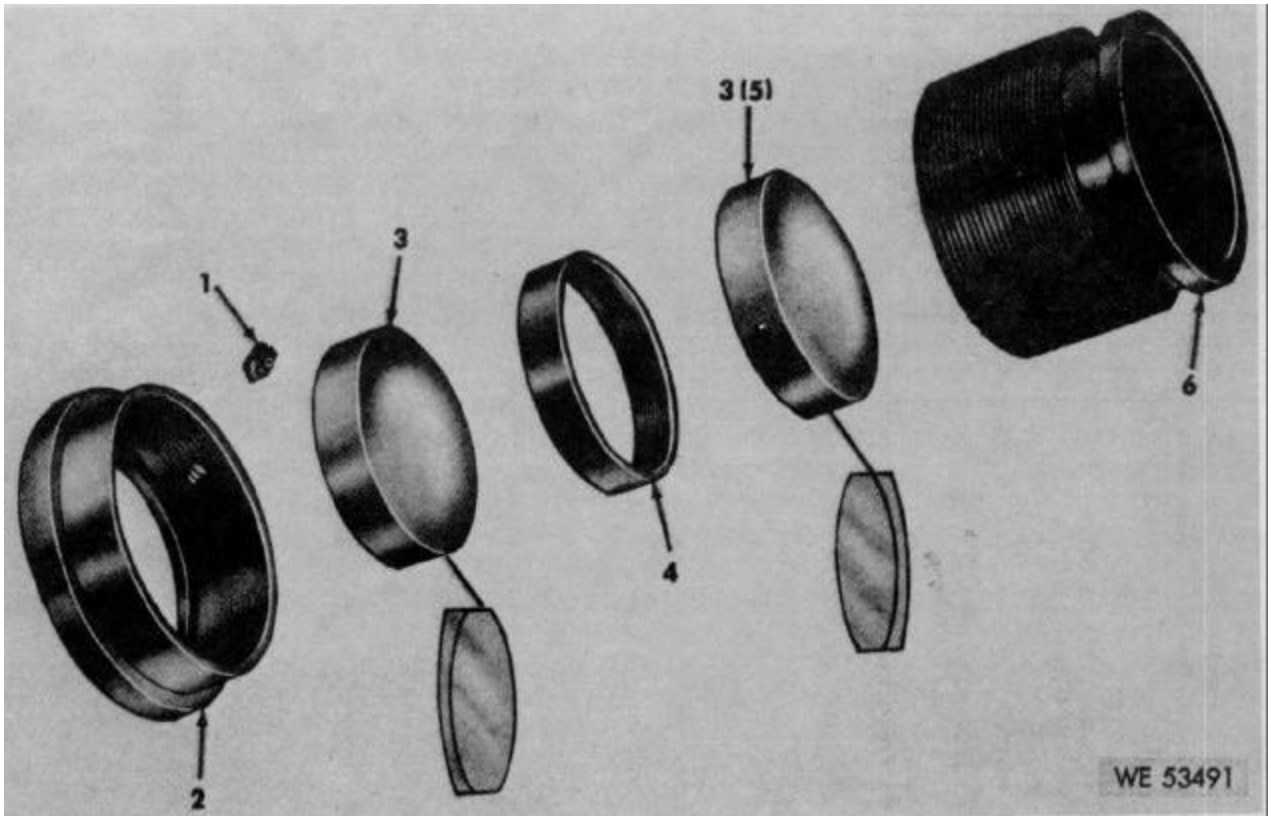

Figure 3. Eyepiece Assembly (7649238) -exploded view.

Act on code	(1) SMR code	(2) Federal stock No.	(3) Description <i>Reference Number &amp; Mfg Code Usable On Code</i>	(4) Unit of Meas	(5) Qty inc in unit	(6) 30-Day DS Maint Allowance			(7) 30-Day GS Maint Allowance			(8) 1-yr alw per 100 equip cntgcy	(9) Depot maint Alw per 100 equip	(10) Illustration	
						(a) 1-20	(b) 21-50	(c) 51-100	(a) 1-20	(b) 21-50	(c) 51-100			(a) Figure No.	(b) Item No.
						C	P-H-	1240-764-9248	<b>RETICLE ASSEMBLY 8286981</b> RING, EXTERNAL RING, AL ALY, 0.521 ID, 0.72, OD, 0.648-48NS-3 EXT THD, 0.147 THK 7649248 (19200)	EA	1			--	--
C	P-H-	1240-987-3220	RETICLE, OPTICAL 8213863 (19200)	EA	1	--	--	--	*	*	1	12	4	4	2
C	P-H-	1240-764-9245	CELL, OPTICAL ELEMENT 7649245 (19200)	EA	1	--	--	--	*	*	1	12	4	4	3

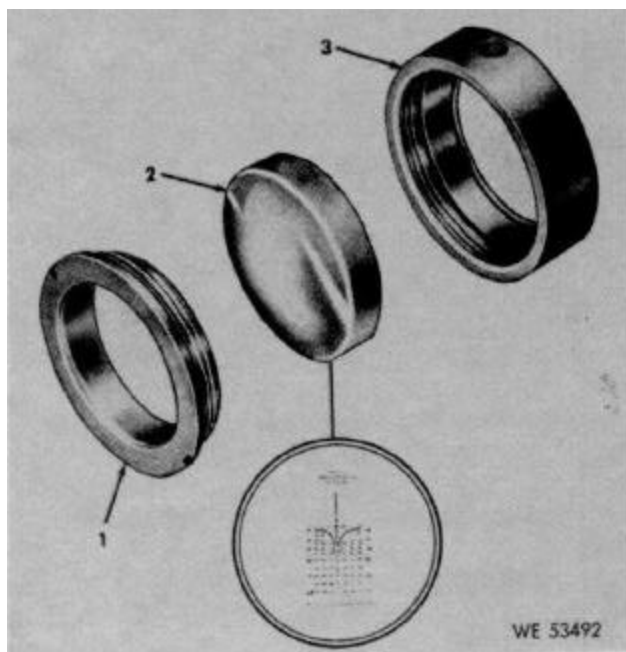

Figure 4. Reticle assembly (8286981) -exploded view.

Act on code	(1)  SMR code	(2)  Federal stock No.	(3)  Description  <i>Reference Number &amp; Mfg Code Usable On Code</i>	(4)  Unit of Meas	(5)  Qty inc in unit	(6)  30-Day DS Maint Allowance			(7)  30-Day GS Maint Allowance			(8)  1-yr alw per 100 equip cntgcy	(9)  Depot maint Alw per 100 equip	(10)  Illustration	
						(a)	(b)	(c)	(a)	(b)	(c)			(a) Figure No.	(b) Item No.
						1-20	21-50	51-100	1-20	21-50	51-100				
N	P-H-	5340-597-8886	<b>OBJECTIVE ASSEMBLY 7649239</b> RING, EXTERNAL AL ALY, 0.625-48NS-3, 0.344 THK 7649247 (19200)	EA	1	--	--	--	*	*	1	12	4	5	1
C	P-H-	1240-503-7657	LENS, OPTICAL INSTRUMENT, OBJEC- TIVE 5037656 (19200)	EA	1	--	--	--	*	*	1	12	6	5	2
C	P-H-	1240-764-9242	CELL, OPTICAL ELEMENT 7649242 (19200)	EA	1	--	--	--	*	*	1	12	4	5	3

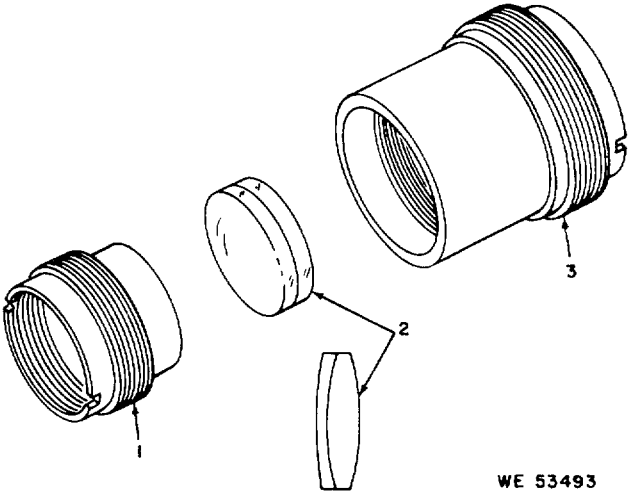

Figure 5. Objective assembly (7649239) -exploded view.

**SECTION IV. INDEX-FEDERAL STOCK NUMBER AND  
REFERENCE NUMBER CROSS-REFERENCED TO  
FIGURE AND ITEM NUMBER**

<i>Stock Number</i>	<i>Figure No.</i>	<i>Item No.</i>	<i>Stock Number</i>	<i>Figure No.</i>	<i>Item No.</i>
1240-346-7676	2	1	1240-764-9252	3	4
1240-503-7651	3	3	1240-987-3220	4	2
1240-503-7657	5	2	5305-057-0500	2	12
1240-507-9525	2	15	5305-057-0524	2	6
1240-759-7275	2	18	5305-068-1654	2	9
1240-759-7277	2	17	5305-068-6708	2	2
1240-763-7894	2	5	5305-753-7062	3	1
1240-764-7118	2	20	5310-928-2690	2	13
1240-764-9242	5	3	5310-929-6395	2	7
1240-764-9244	2	8	5315-806-7039	2	16
1240-764-9245	4	3	5315-844-3942	2	21
1240-764-9246	3	6	5340-597-0717	2	19
1240-764-9248	4	1	5340-597-8886	5	1
1240-764-9249	3	2	9905-223-7172	2	14
1240-764-9250	2	4			

<i>Reference No.</i>	<i>Mfr code</i>	<i>Figure No.</i>	<i>Item No.</i>	<i>Reference No.</i>	<i>Mfr code</i>	<i>Figure No.</i>	<i>Item No.</i>
MS16555-604	96906	2	16	7649238	19200	2	3
MS16562-6	96906	2	16	7649239	19200	2	11
MS35338-134	96906	2	13	7649244	19200	2	8
MS25338-136	96906	2	7	7649245	19200	4	3
MS51031-8	96906	2	9	7649246	19200	3	6
MS51958-28	96906	2	6	7649247	19200	5	1
MS51958-4	96906	2	12	7649248	19200	4	1
M551038-16	96906	2	2	7649249	19200	3	2
5037651	19200	3	3	7649250	19200	2	4
5037657	19200	5	2	7649252	19200	3	4
541823	00000	3	1	8213863	19200	4	2
7597275	19200	2	18	8228878	19200	2	1
7597277	19200	2	17	8286926	19200	2	14
7637894	19200	2	5	8286981	19200	2	10
7646896	19200	2	19	8299681	19200	2	22
7647118	19200	2	20	8299684	19200	2	15



By Order of the Secretary of the Army:

Official:

W. C. WESTMORELAND,  
*General, United States Army,*  
*Chief of Staff.*

KENNETH G. WICKHAM,  
*Major General, United States Army,*  
*The Adjutant General.*

DISTRIBUTION:

To be distributed in accordance with DA Form 12-41 (qty rqr block #142) Direct and General Support Maintenance requirements for Telescope, Elbow.

DEPARTMENT OF THE ARMY  
US ARMY AG PUBLICATIONS CENTER  
1655 WOODSON ROAD  
ST. LOUIS, MISSOURI 63114

OFFICIAL BUSINESS  
PENALTY FOR PRIVATE USE \$300

POSTAGE AND FEES PAID  
DEPARTMENT OF THE ARMY  
DOD 314



**TM 9-1240-356-35P**

**PIN: 027306-000**